



HANA Umami Black Moving Coil Phono cartridges Owners Manual

Umami Black cartridge is Low-Output Type. Operate with Step Up Transformer or MC/Phonostage.

HANA Umami Sound — Wonderful Taste in Music

■What is HANA-Umami Sound?

Umami Sound is a uniquely captivating musical experience—an exceptional sensuality that immerses you in the performance and leaves a lasting emotional impression. It is music that brims with harmonic richness, delicate textures, pinpoint imaging, sweet highs, solid bass, rhythmic vitality, and lifelike dynamics. Most of all, it offers the rare “you-are-there” presence that elevates music listening into something unforgettable.

Just as umami in cuisine describes a deep and satisfying flavor created through a perfect blend of ingredients and techniques, Umami Sound represents this same concept for your ears—a harmonious, synergistic fusion that delivers more than the sum of its parts. It’s the wonderful taste in music.

■Crafted by a Master

Master cartridge designer Masao Okada-san of Excel Sound celebrates over 5 decades of innovation and excellence. His deep expertise brings Umami Sound to life, blending state-of-the-art materials with time-honored Japanese craftsmanship and continued advancements in audio engineering.

The HANA Umami Legacy

The HANA-Umami Black continues the brand’s legacy of “Brilliant and Gorgeous” sound. In 2020, the HANA-Umami Red introduced the concept of Umami Sound to the world, earning widespread acclaim. The 2023 arrival of the HANA-Umami Blue further proved that these core design principles can offer a singular and emotionally powerful experience to more music lovers. Okada-san’s latest vision comes to life with the HANA-Umami Black the new flagship, offering an even more profound expression of the Umami philosophy.

HANA-Umami Black – A New Reference in Analog Playback

The HANA-Umami Black is Okada-san’s new masterpiece. It features a diamond cantilever and new “OKD” High-Efficiency Moving Coil Generator, and delivers pure musical enjoyment that elevates the listener’s experience to new heights.

●Diamond Cantilever

In a category first for HANA, the Umami Black incorporates a diamond cantilever, the hardest possible material, ideal for signal transfer. Its exceptional rigidity ensures direct and precise transmission of groove modulations to the generator, preserving every detail and dynamic shift with astonishing clarity.

●High-Efficiency “OKD” Moving Coil Generator

Another category first, the Umami Black uses the newly developed “OKD” with the world’s first “Integrated Pole Piece and Rear Yoke” and Inverted U-shaped Front Yoke, optimizing energy transfer from the diamond cantilever while reducing unwanted resonance. The breakthrough OKD Generator is cryogenically treated to increase signal purity.

●Inverted U Front Yoke

The U-shaped (bifurcated) inverted front yoke is engineered for both mechanical resonance control and magnetic field alignment, while also providing precise support for the diamond cantilever. This U-shaped structure minimizes resonances, channeling significantly less energy into overtone modes due to its shape and proportions. The open-bottom design of the U Front Yoke creates a more homogenous flux field for the magnetic generator, reducing saturation, and precisely locates the diamond cantilever, eliminating tracing error.

The body’s exquisite Urushi lacquer finish reflects traditional Makie Japanese artistry. A meticulous, multi-stage process—beginning with a black Urushi undercoat, followed by silver powder infusion, gold powder “hana” name detailing, and final polishing—produces a finish of rare visual and sonic richness for the Umami Black.

●High-Power Rare Earth Magnet and Hybrid Armature

Unique to the Umami Black, the rare earth neodymium-iron-boron (NdFeB) magnet is used for the high-efficiency generator, delivering superior energy conversion. A 2mm square hybrid Carbon permalloy armature, comprising 78% carbon-infused nickel-iron, is precisely hand-wound with 30-micron, 4N high-purity copper wire on Excel’s proprietary machinery. This ultra-light moving coil has an output of 0.3mV at 5 ohms, ideal for both modern MC phono stages (both voltage

and current amplification circuits) and step-up transformers.

●Auricle™ Cartridge Body

At the heart of the Umami series lies the exclusive Auricle™ body design, engineered to rigidly support the “Open Air” Moving Coil generator. Inspired by the shape of the human outer ear, it is machined from A7075 aircraft-grade aluminum, among the strongest and lightest alloys available. The Umami Black body features a black zirconia inlay on its face for added damping and visual elegance. Tapped and threaded mounting holes ensure optimal tonearm integration, enhancing focus, dynamics, and low-frequency definition.

●Special Urushi Enameled Finish

The HANA-Umami Black features an exquisite Urushi lacquer finish, inspired by traditional Makie Japanese artistry. Applied through a specialized thermosetting process at 120 C, the lacquer bonds to the aluminum body via vapor deposition, creating a durable, high-gloss surface. This multi-stage treatment not only adds visual elegance—it also serves a functional purpose: by controlling resonances, it enhances clarity, imaging precision, and bass definition, contributing to the Umami Black’s uniquely rich sonic signature.

●Microline Stylus

The “nude” natural diamond Microline stylus mirrors the shape of the original cutting head stylus used in mastering vinyl records. With a .22mm square profile and precisely mounted to the diamond cantilever, it captures the subtlest musical nuances.

●Cryogenic Processing

Cryogenic treatment enhances metal properties by subjecting them to extremely low temperatures, typically below -300° F (-184° C), to refine their microstructure for enhanced conductivity, reduced distortion, and remarkable tonal purity. All magnetic and signal path components—U front yoke, integrated pole piece/rear yoke, and 24k gold-plated brass output pins—are subjected to deep cryogenic treatment.

●Hand-Built in Japan

Each HANA-Umami Black cartridge is meticulously handcrafted by Excel Sound’s skilled artisans in Japan. With 55 years of tradition and excellence, every cartridge is assembled with precision and care. The result is music that merges the signature HANA brilliance with the evocative Umami Sound. Every detail reflects a dedication to musical beauty, ensuring an experience that is both intensely satisfying and unmistakably HANA.

●A Masterwork of Musical Synergy

From its materials to its manufacturing, every element of the HANA-Umami Black exemplifies the synergy of Umami Sound. Under the direction of master cartridge designer Masao Okada-san, modern audio engineering harmonizes with time-honored Japanese craftsmanship to deliver a musical experience beyond your expectation. The HANA-Umami Black embodies this synergy, delivering the unmistakable essence of Umami Sound—an emotional, immersive, and truly musical experience.



HANA Umami Black Moving Coil Phono cartridges Owners Manual

Umami Black cartridge is Low-Output Type. Operate with Step Up Transformer or MC/Phonostage.

■Installation

Depending on your headshell / tonearm design, you may wish to fit the cartridge leads before mechanically connecting cartridge to the headshell (see details below and on the right).

●Connecting with Headshell

Use the Allen key supplied to tighten both fixing screws into the captive nuts in the cartridge body. Pay careful attention that the cartridge is not twisted or angled when attaching to the headshell. Make sure that there are no foreign objects between the cartridge body and the headshell. Do not use excess force that might strip the screws or distort the body of the cartridge.

We recommend that you use cartridge alignment protractor and tools (not supplied) to ensure the **Umami Black** cartridge is properly aligned in the headshell and tonearm. For optimum sound quality, it is important to assure correct overhang, offset angle, azimuth and VTA (as with all cartridges). We suggest you get your Hi-Fi Dealer to assist with this if you do not have the correct equipment and skills.

Umami black Moving Coil Cartridge Specification

Body	Material	Duralumin (A7075)
	Shape	Auricle open air
	Finish	Urushi lacquer
Cantilever Assy	Cantilever	Diamond
	Stylus	Microline Nude Diamond
Magnetic Circuit	Structure	"OKD" generator with Inverted U Front Yoke and Integrated Pole Piece and Rear Yoke
	Armature material	Permalloy, 78% carbon-infused nickel-iron
	Armature Shape	2mm Square Plate
	Parts material	Pure Iron
	Magnet	Neodymium (NdFeB)
Coil	Coil Impedance	5 Ω
	Output	0.3mV
	Load Impedance	≥50 Ω
Treatment	Cryogenic	"OKD" generator with U Front Yoke, Integrated Pole Piece and Rear Yoke, Gold-plated Terminal Pins
Specification	Frequency Response	15-50,000Hz
	Output Balance	0.5dB/1KHz
	Channel Separation	30dB/1KHz
	Tracking Weight	2g
	Trackability	70 μm/2g
	Dynamic Compliance	10 x 10(-6) cm/dyne (100Hz) Estimated at 17 x 10(-6)cm/dyne at 10Hz
	Cartridge Weight	11.3g

●Connecting with signal lead out wires

Slide headshell lead wire clips over to each **Umami Black** terminal pins, reminding you to carefully expand clip if needed to best suit pin size.

Red : Right positive (+)

Green : Right negative (-)

White : Left positive (+)

Blue : Left negative (-)

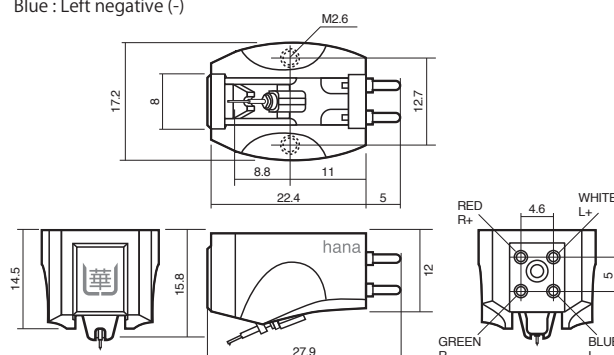

●VTF (Vertical Tracking Force) setting:

Nominal VTF is 2.0g for **Umami Black**.

Note: Increase the VTF value slightly if the room temperature is below 20 degrees Centigrade (68 degrees Fahrenheit). However, The cartridge will warm up after playing music for a few minutes, increasing compliance slightly due to the kinetic energy of the disk.

■Caution

●Be sure not to damage vulnerable cantilever or stylus when connecting to headshell. Keep the stylus protector fitted when attaching to headshell.

●Never solder headshell lead wires directly to **Umami Black** terminal pins as this may damage inner cartridge moving coil wires.

●Do not put any unnecessary pressure on cantilever/stylus with fingers, which is carefully tuned at the factory. Unusual pressure will cause moving coil cartridges to lose their factory set compliance.

To clean the stylus, use the included small brush. Gently move the brush from back to front (moving from cantilever base to stylus tip) to remove dust or debris build up during playback.

■Warranty

The manufacturer's warranty will apply to normal usage and operation for 2 years after purchase date or shipping date from the manufacturer at Excel's discretion. The warranty does not apply to any damage from abuse. This will be determined by manufacturer for warranty eligibility. The warranty covers defects in materials and craftsmanship, but not abuse or wear of stylus tip due to use. Please handle your **Umami Black** cartridge carefully. Do not use excess force when installing or cleaning your cartridge. If you are unsure, please ask your Dealer for assistance. If you accidentally damage your cartridge, the manufacturer does offer a generous retip replacement plan. This also applies to cartridges that are out of the warranty period.



Important cartridge fixing instructions:

As illustrated right: Select the correct length of 2.6M screw (4mm, 5mm, 6mm 8mm lengths provided) to suit your tonearm's headshell thickness.

The depth of threaded holes in Umami body is only 3mm. Using too long of a screw could damage the cartridge when tightening.

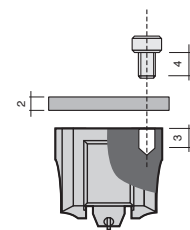

Printed in japan