

DS E3

Instruction Manual

Table of contents

▶ Checking the supplied items	1
▶ Notes on safe operation	2
▶ Names and functions	3.4
▶ Caution	5
▶ Trouble shooting Specification	6
▶ Warranty	7

Supplied items

If any items missing, please contact our authorized dealer or DS Audio.

DS-E3 Optical Cartridge



Needle cover

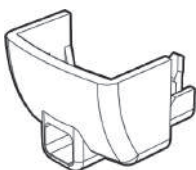

**Cartridge screw (M2.6)
+hexagonal wrench**

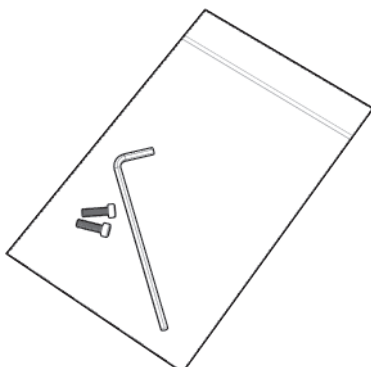

DS-E3 Equalizer

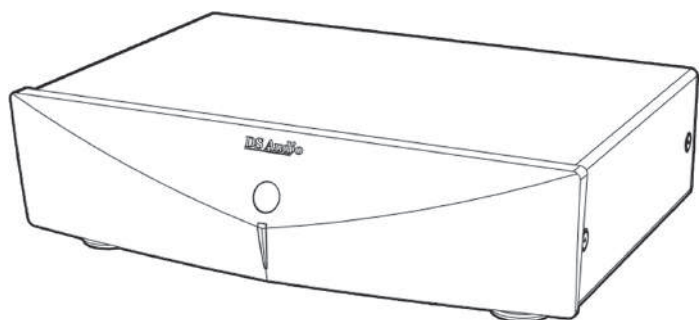

Power cable

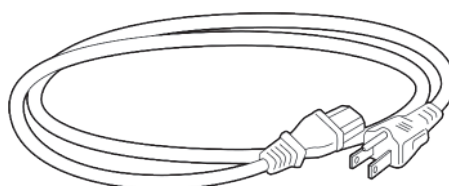

Instruction manual



Notes on safe operations

Initial setup

- Place the player in a location with adequate ventilation to prevent heat buildup of the apparatus.
- Do not place the player on a soft surface such as a rug that might block the ventilation holes on the bottom.
- Do not place the player in a location near heat sources, or in a place subject to direct sunlight, excessive dust or mechanical shock.

Power requirements

- [V AC, 50 / 60 Hz]

POWER-CORD CAUTION

- Handle the power cord by the plug. Do not pull out the plug by tugging the cord. Never touch the power cord when your hands are wet as this could cause a short circuit or electric shock. Do not place the unit, a piece of furniture, etc., on top of the power cord, or pinch the cord. Never make a knot in the cord or tie it with other cords. The power cords should be routed such that they are not likely to be stepped on. A damaged power cord can cause fire or give you an electrical shock. Check the power cord time to time.

On repair

- Please consult our authorized dealer nearest to you.

Break-in

- **Since a large amount of electrolytic capacitors are used for the DS-1000, it takes time to break in. You can enjoy better sound by leaving the power on 24 hours after purchase for several months.**

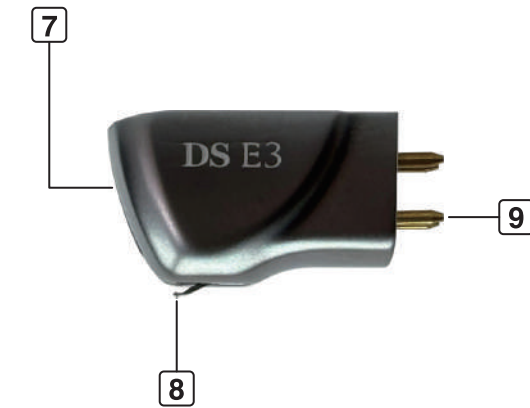
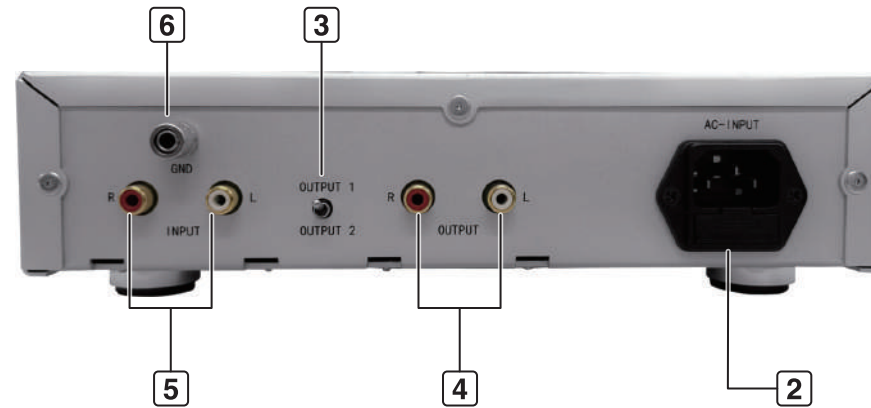
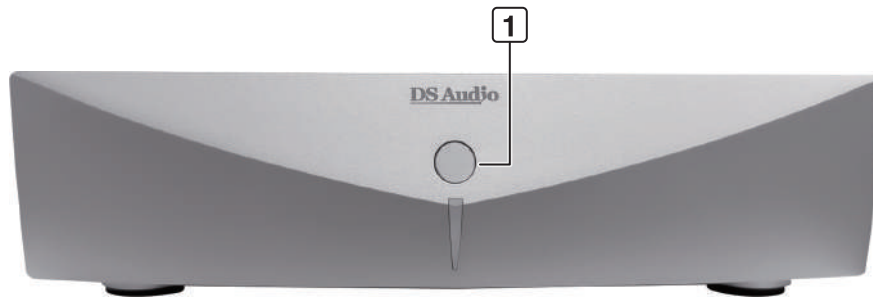

1 Power Switch Power On / Off button

2 Power inlet terminal
Connect to the power outlet with the supplied AC power cable.

3 OUTPUT switch
Subsonic filter ON/OFF can be selected.
Output1: Standard output compliant with RIAA. Normally, this output is recommended.
Output2: This output has a subsonic filter (20Hz -6dB/oct) added to the standard output. Use this output when the woofer moves significantly due to record warping, etc.

4 RCA output (Line out)
Both Output1 and Output2 are LINE outputs, so connect them to the AUX jack or other line-level input jacks. (Do not connect to the Phono input).

5 INPUT
L / R channel lines of your turn table player are connected to those terminals. Make sure that each channel is connected to the same channel, while Optical cartridge is taking power out from those lines, Misconnection may damage the cartridge.
*Do not connect MM/MC cartridge to this Equalizer. It may break MM/MC cartridge.

6 GND
Connect the ground line of your turn table player

7 Power indicator LED
LED indicates power being on when it is lit. When Equalizer is turned on, yet LED is not lit, check the Cartridge connection and Equalizer connection

8 Cantilever / Stylus
Adjust the Stylus pressure carefully as to the recommended pressure range. Do not remove the film on the bottom as it is a dust prevention film.

9 Output pins
Connect Output pins as described in "Output pin connection".

⚠ Precautions

1. Clean the cabinet, panel, and controls with a soft cloth slightly moistened with a mild detergent solution. Do not use any type of abrasive pad, scouring powder, or solvent such as alcohol or benzine.
2. Operational temperature should be 20degree C to 26degree C. Warming up is recommended in winter time.
3. This optical cartridge is Amplitude proportional signal read out. It required our designated equalizer. Outputs from the equalizer should be connected to CD / AUX terminals of your amplifier. Do not connect to Phono terminals.

"Output pin connection"



◀ Stylus Replacement ▶

Stylus replacement is available at DS Audio. Please consult our authorized dealer for its cost and time.

Caution

You are cautioned that any changes or modifications not expressly approved in this manual could void your authority to operate this equipment.

To reduce the risk of fire or electrical shock, do not expose this apparatus to rain or moisture.



WARNING



Do not operate this equipment when it is broken

When it is broken, do not turn the power on. Unplug the AC power line and keep the switch turned off. Turning the power on may cause fire or smoke. Do not open the cabinet to avoid electrical shock.



Do not make any changes or modification

You are cautioned that any changes or modifications not expressly approved in this manual could void your authority to operate this equipment.



Keep away from water/moisture

To reduce the risk of fire or electrical shock, keep this apparatus away from water / moisture.



No liquid nearby

To reduce the risk of fire or electrical shock, do not place drinks/any liquid nearby for precaution.



Do not open the cabinet

Should any solid object or liquid fall into the cabinet, unplug the player and have it checked by qualified personnel before operating it any further.



CAUTION



Place this apparatus firmly

Avoid placing this apparatus on unstable table. Do not tilt the apparatus.



Away from heat and dust

Avoid placing this apparatus in dusty place / high temperature



Connections to other devices

When connecting this apparatus, please refer to the setup manual of connecting devices

Trouble shooting

Should any problem persist after you have checked those symptoms, please consult our authorized dealer nearest to you.

Symptom	Cause	Corrective action
No Power	No AC power	Check the power cord connected securely. When plugs are dirty, clean the plugs with a dry soft cloth periodically.
No sound	Loose connection	Connect signal plugs firmly. When plugs are dirty ,Clean the plugs with a dry soft cloth periodically.
Hamming noise	Loose Ground connection Plugs are dirty	Connect ground line firmly. place it away from noise source such as transformer / motor
No sound when switched on	This EQ contains ample capacitance for the best sound quality. It takes few minutes to warm up.	we recommend one minute of warm up time

Specifications

DS-E3

DS-E3 CR

Signal output	Phono-electric Conversion
Output Signal level	70mV (1kHz)(at Cartridge output)
Channel Separation	26dB and more(1kHz)
Needle Pressure	2.0g~2.2g(2.1g is Recommended)
Canti-lever	Aluminum
Stylus	ellipse
Weight	7.7 g
Body Material	Aluminum

DS-E3 EQ

Rated output voltage	500mV(1kHz)(at Equalizer output)
Input terminal	RCA Terminal
Output Terminal	RCA Terminal
Size	260W×69H×195D (mm)
Impedance	120 Ω
Weight	1.86 kg

Warranty

WARRANTY

Owner's Record

The model and serial numbers are located on the bottom. Record the serial number in the space provided below. Refer to these numbers whenever you call your Cartridge dealer regarding this product.

Model No. DS-E3

Serial No. _____

WARNING

To reduce fire or shock hazard, do not expose the unit to rain or moisture.

IMPORTANT SAFETY INSTRUCTIONS

-SAVE THESE INSTRUCTIONS

-TO REDUCE THE RISK OF FIRE OR ELECTRIC SHOCK, CAREFULLY FOLLOW THESE INSTRUCTIONS

LIMITED WARRANTY

DS Audio warrants this product against defects in material or workmanship for the time periods as stated below. Pursuant to this Limited Warranty, DS Audio will, at its option, (1) repair the product using new or refurbished parts or (2) replace the product with a new or refurbished product. For the purposes of this warranty, "refurbished" means a product or part has been returned to its original specifications. In the event of a defect, these are your exclusive remedies.

For a period of one (1) year from the original date of purchase of the product, DS Audio, at its option, repair or replace with new or refurbished product, product determined to be defective.

This limited warranty covers only the hardware components packaged with the product. It does not cover technical assistance for hardware.

Instructions: To obtain warranty service, you must deliver the product, freight prepaid, in either its original packaging or packaging affording an equal degree of protection to the DS Audio authorized service facility specified.

Any parts or product replaced under this limited warranty will become the property of DS Audio.

This limited warranty only covers product issues caused by defects in material or workmanship during ordinary consumer use. It does not cover product issues caused by any other reasons, including but not limited to product issues due to commercial use, acts of God misuse, limitation of technology, or modification of any part of product.

This limited warranty is invalid if the factory-applied serial number has been altered or removed from the product.

This limited warranty is valid with the official receipt of our authorized dealer which indicating the date of your purchase.